

接线图 WINDING DIAGRAM

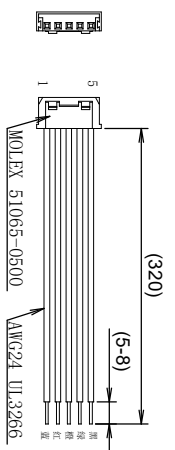
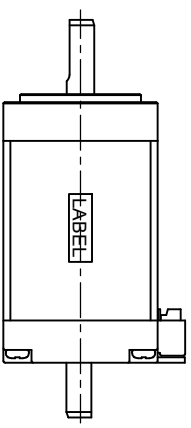
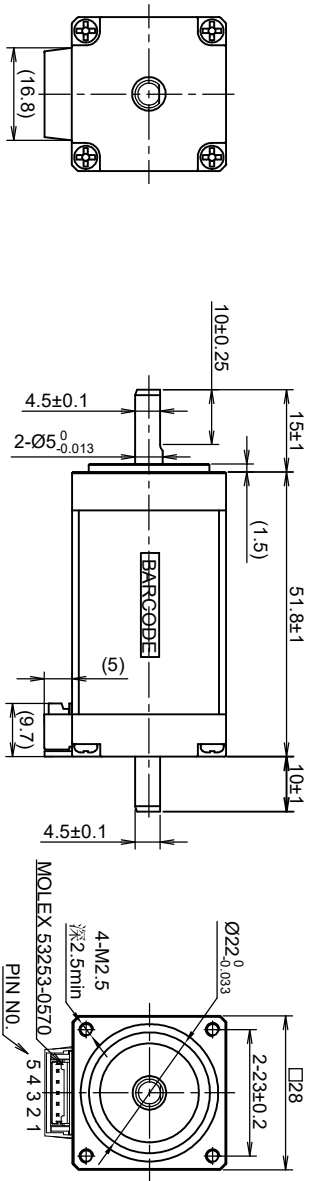

励磁顺序VS旋转方向  
Exciting Sequence vs. Direction of Rotation

| STEP | 黑<br>Black | 绿<br>Green | 橙<br>Orange | 红<br>Red | 蓝<br>Blue |
|------|------------|------------|-------------|----------|-----------|
| 1    | +          | +          | -           | -        | -         |
| 2    | +          | -          | -           | -        | +         |
| 3    | +          | -          | -           | +        | +         |
| 4    | -          | -          | -           | +        | +         |
| 5    | -          | -          | +           | +        | +         |
| 6    | -          | -          | +           | +        | -         |
| 7    | -          | +          | +           | +        | -         |
| 8    | -          | +          | +           | +        | -         |
| 9    | -          | +          | +           | +        | -         |
| 10   | +          | +          | +           | -        | -         |

从安装面看为顺时针方向  
Clockwise/view from mounting side

Barcode ID

barcode label

电机参数 MOTOR SPECIFICATIONS

|                              |                            |
|------------------------------|----------------------------|
| 步进角 STEP ANGLE               | 0.72°±5%                   |
| 额定电流 RATED CURRENT           | 1.2 Amps/PHASE             |
| 保持力矩 HOLDING TORQUE          | 0.09 N.m MIN.              |
| 电阻 RESISTANCE                | 0.9 ohm±0.15 AT 20°C       |
| 电感 INDUCTANCE                | 0.45 mH±20% AT 1kHz, 1Vrms |
| 转子惯量 ROTOR INERTIA           | 18 g.cm <sup>2</sup>       |
| 绝缘等级 INSULATION CLASS        | CLASS B                    |
| 绝缘耐压 DIELECTRIC STRENGTH     | 500V A.C 1MINUTE           |
| 防护等级 IP CODE                 | IP 20                      |
| 重量 WEIGHT                    | 200 g                      |
| 温升 TEMPERATURE RISE          | 80K MAX.                   |
| 运行环境温度 OPERATING TEMPERATURE | -10°C---+50°C              |
| 允许轴向负载 SHAFT AXIAL LOAD      | ---N                       |
| 允许径向负载 SHAFT RADIAL LOAD     | ---N                       |

电机型号 MOTOR CODE

E5W11-312D

步进电机规格书

单位/UNIT: mm  
未标注长度及角度默认公差  
UNLESS OTHERWISE SPECIFIED TOLERANCES

长度/DIMENSIONS: ±0.3mm  
角度/DEGREES: ±5%



Motor inspection standard: QC-ZL-011

| REV. | DATE     | REVISIONS     | BY    |
|------|----------|---------------|-------|
| A    | 26-03-26 | first version | CAROL |

www.czaiwei.com



APPROVED

John